

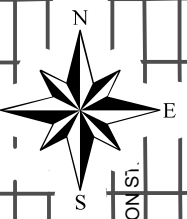





LAKE RIDGE SCHOOL CORPORATION

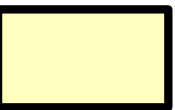

**FILE BY DISTRICT
ELECTED AT LARGE**

-  1ST DISTRICT
-  2ND DISTRICT
-  3RD DISTRICT

-  Road Centerlines
-  Railroads
-  Water lines

**JAMES L. WIESER
DEMOCRAT CHAIRMAN**

**RANDELL NIEMEYER
REPUBLICAN CHAIRMAN**

PREPARED BY
LAKE COUNTY BOARD OF
ELECTIONS & REGISTRATION
FOR REFERENCE ONLY

